



ASPIRE

— TO MOVE —



Merchants Almshouse, King Street, Bristol, BS1

Video and physical viewings available. One bedroom furnished flat located in the heart of Bristol City centre. It would ideally suit a single professional, couple or student, looking to enjoy the hustle and bustle of city centre living. Available 23rd July.

King Street is on your doorstep, home to lots of bustling pubs, bars, restaurants and the Bristol Old Vic theatre. To enjoy open green space, Queen Square is just across the road. For commuters, the airport shuttle and the main bus lines stop less than 1 minute away and Bristol Temple Meads train station is only 15 minutes away by walk.

- One bedroom flat
- Furnished
- Available 23rd July
- Video viewing available
- Council tax band A - £1,809.12
- Holding deposit: £276
- City centre location
- Communal courtyard

£1,200 PCM

Floor Plans

GROUND FLOOR 406 sq.ft. (37.7 sq.m.) approx.

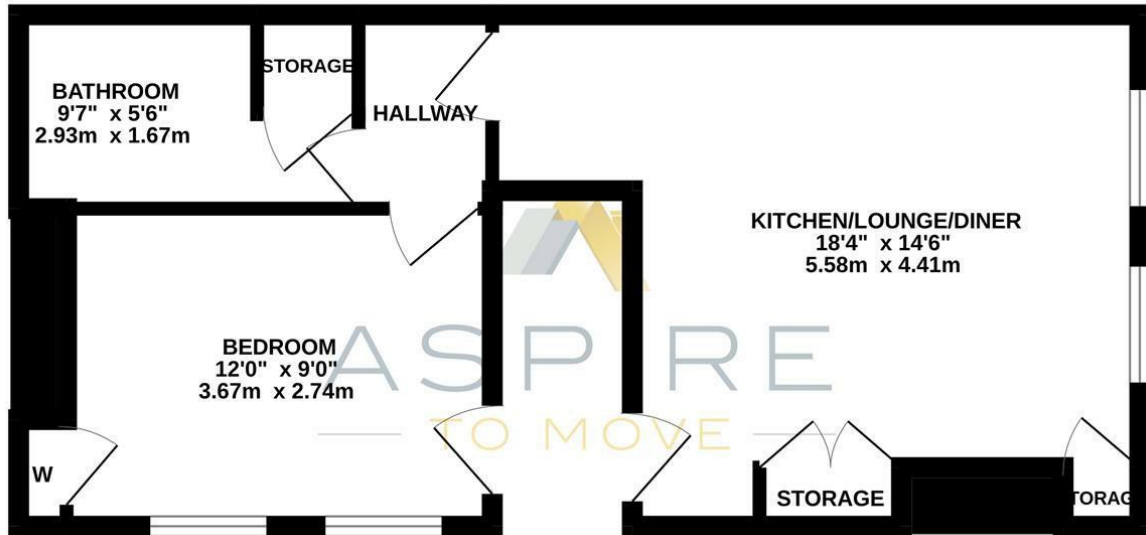

MERCHANTS ALMSHOUSES, BRISTOL, BS1

TOTAL FLOOR AREA : 406 sq.ft. (37.7 sq.m.) approx.

Whilst every attempt has been made to ensure the accuracy of the floorplan contained here, measurements of doors, windows, rooms and any other items are approximate and no responsibility is taken for any error, omission or mis-statement. This plan is for illustrative purposes only and should be used as such by any prospective purchaser. The services, systems and appliances shown have not been tested and no guarantee as to their operability or efficiency can be given.
Made with Metropix ©2024

Energy Performance Graph

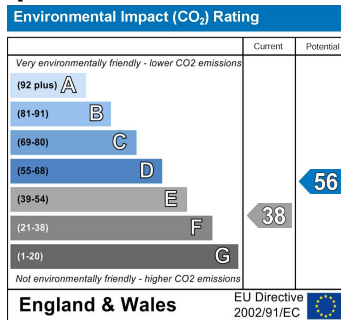
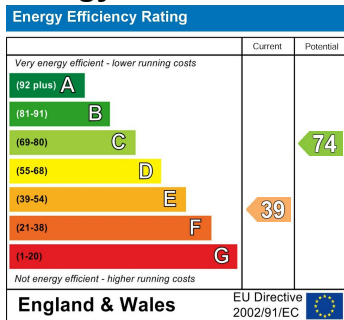

These particulars, whilst believed to be accurate are set out as a general outline only for guidance and do not constitute any part of an offer or contract. Intending purchasers should not rely on them as statements of representation of fact, but must satisfy themselves by inspection or otherwise as to their accuracy. No person in this firm's employment has the authority to make or give any representation or warranty in respect of the property.